



## BUTLER® LANDMARK™ 2000 STRUCTURAL SYSTEMS

### FEATURES & BENEFITS:

- Truss PurlinXT allows for up to 60' bays, and is available in 30", 34", and 40" depths.
- Acrylic-coated galvanized trusses protect from corrosion and provide an attractive interior appearance.
- Factory-assembled, factory-punched structural members simplify erection.
- Design flexibility allows for a combination of roof slopes and ridge designs.
- Provides an economic design solution for buildings that require wide-open interior space.
- Integrates with conventional wall products, such as masonry, precast concrete, site-cast tilt wall and nonmetal curtain walls.



**RAINWATER**  
CONSTRUCTION COMPANY

## EXPERTS AT BUTLER® LANDMARK™ 2000 STRUCTURAL SYSTEMS FEATURING TRUSS PURLIN XT™

### THE RIGHT CHOICE FOR WAREHOUSE & DISTRIBUTION

In warehouse and distribution construction, space is everything. That's why the Butler Landmark™ 2000 Structural System is designed to allow for the longest bay sizes on the market. When you build with Butler, you get a system that eliminates unnecessary interior footings and columns for a space that is flexible, functional and highly usable.

The Landmark™ 2000 structural system combines solid-web primary frames, factory-punched Truss Purlin XT™ secondary structural members and rod bracing to form a long-bay framing system that can span up to 60 feet. This truss purlin system (with open-web secondary structurals) is a Butler exclusive.



## TRUSS PURLIN XT™

### FEATURES & BENEFITS:

- Galvanized for Speed and Accuracy in Assembly.
- Factory-punched Chords for Precise Roof Panel Attachment.
- Mechanically Attached Bridging Reduces On-Site Labor.
- Single-Slope, Double-Slope and Offset Ridge Options Provide Design Flexibility.

## RAINWATER CONSTRUCTION & BUTLER MANUFACTURING

### A WINNING COMBINATION FOR THE WAREHOUSE AND DISTRIBUTION INDUSTRY

The Rainwater Construction Company are Butler Building experts, renowned for our efficiency in managing timelines and budgets and collaborating with designers and architects to produce highly functional warehouse and distribution space that will perform over the long-term. We have constructed millions of square feet over our decades in operation and pride ourselves on delivering quality construction on-time, on-scope, and on-budget.

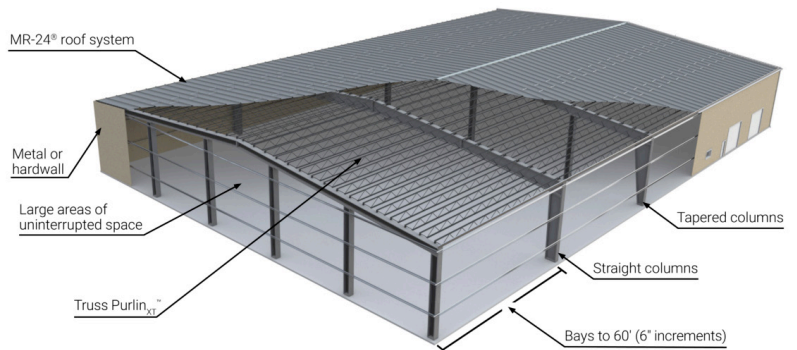

**RAINWATER**  
CONSTRUCTION COMPANY

CALL: (404) 636-8615

VISIT: [RAINWATERCONSTRUCTION.COM](http://RAINWATERCONSTRUCTION.COM)